

Aluminium façade systems

WICTEC®



Why WICONA?

Because as a successful aluminium systems company based in Germany, WICONA has more than 60 years' experience – experience from which you can benefit on a daily basis.

Not only are we able to fulfil the role of a reliable and co-operative supplier, but you can also enjoy the advantages of a strong, technologically advanced brand that has enjoyed long-term success in the market.

At WICONA, every detail counts: from detailed planning to the perfect processing material and rapid delivery right through to active sales support. That's why you should choose WICONA!





Contents

WICONA Unisys	4
WICTEC - in general	6
WICTEC 50 Stick construction façade	8
Variants	10
HI High-insulation façade	
Industrial façade	
Integrated pressure profile	
WICTEC 50P Mullion/mullion façade	
WICTEC 50E Mullion/mullion façade	
WICTEC 50A Surface mounted construction	
WICTEC 60 Stick construction façade	12
WICTEC Unitized façades	14
WICTEC EL	
WICTEC EL60	
WICTEC 50EL	
WICTEC FF Window façade	18
WICKSKY 3 Structural glazing façade	20
WICTEC 50SG Structural glazing façade	
Safety and Security	22
Burglar resistance	
Bullet resistance	
Fire protection	
Innovation	24
Integrated sun shade	
TEmotion	
WICSOLAIRE	
Support and advice on site	26
Overview	28

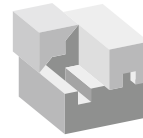

WICONA[®] Unisys

Reduced complexity!

WICONA Unisys – a standard system with a wide variety of applic

WICONA Unisys simplifies processing steps and enables more rapid processing, saving both costs and time.



ations

Quality, freedom of design, familiarity of processes and simplicity of processing form the tangible benefits of aluminium façades by WICONA. Whatever the requirements may be, WICTEC profiles coupled with your own specialist expertise make it possible to provide individual, tailor-made façades. What is more, our products are always simple to install. The reason: the WICONA Unisys principle even applies to our range of façade systems.

WICONA Unisys is a modular concept used in the design of all WICONA systems. When constructing a façade, you are able to make use of the same processing steps, accessories, gaskets, sealants and jointing systems. WICONA Unisys also means that it is very simple to upgrade the façade in order to provide burglar-resistance or bullet-resistance or to enhance fire protection. This means that overall, WICONA constructions offer maximum flexibility, are more cost-effective, safer and quicker to install.



WICONA Unisys Advantages at a glance

- Familiarity of processes due to the use of the same components, processing steps and tools
- Time savings as less time is needed for research, training and production
- Cost savings due to reduced number of parts and less storage space required
- Consistent availability of goods and consistent module size of the standardised individual components

WICTEC® – Experiencing innovative façade



WICTEC is so much more than just the name of a group of products.

It stands for the very latest brand of attractive and functional aluminium profile façade design.

WICTEC makes façade technology fascinating – for you as the metal construction experts just as much as for your customers. It encompasses an overall concept of modern-day architecture that reconciles the elements of heat store, air conditioning, light provider, sun screen, fire and noise protection and design within one single façade construction.

With WICTEC you can be sure to meet these multifunctional requirements. And it makes no difference whether your client is the little baker's shop round the corner or an elegant company HQ located in a major city.

It is up to you to use WICTEC façades to create prominent constructions within the urban landscape, turning design sketches into physical realities. What we at WICONA want is that you have a real sense of this fascination and can therefore also inspire a similar enthusiasm in your customers. With this in mind we are not only working on new developments but also just as intensively on concepts and details that can help you to leave the competition behind in your normal day-to-day business.

de technology

WICTEC is synonymous with façades!

Whether you require classic stick construction designs, unitized, window or structural glazing façades through to three-dimensional designs such as pyramids, polygons, barrel vaults or cupolas – with WICTEC anything is possible. Thanks to the WICONA Unisys principle and the compatibility with WICONA window, door and sliding systems, WICTEC offers an exceptionally flexible façade system. The range of possible technical options and the design freedom are enormous. Example: Narrow elevation widths. They epitomise the latest look but not all WICONA designs look exactly the same, as you, the planner, and your customers have a choice of five face widths ranging from 50 to 90 mm. A further example is the WICTEC 50EL prefabricated unitized façade, made from standard parts. This can be used if a particularly rational assembly process is required with a correspondingly fast construction process.

In times like these that are characterised by high energy prices, the need to make the most efficient use of energy and to protect our climate, the best possible thermal insulation is one of the most important properties of a façade. WICONA is a pioneer in thermal insulation systems, whether these take the form of high-quality coatings for the profiles or on the basis of special design features. We can work with you to develop technical solutions for energy-optimised and sustainable building concepts which will continue to meet the requirements of modern constructions for many years.

The benefits of WICTEC at a glance:

- Based on the WICONA Unisys principle:
High level of process security, cost and time savings, simple production, fewer tools required due to use of standard components
- Regular grading of profile depths means cost-effective adaptation to various structural requirements and optimised use of materials
- Functional safety due to graded, continuous drainage (Levels E1 to E3).
- The simplest mullion-transom joints – with or without connectors
- Rotatable gaskets to achieve polygonal designs
- WICTEC AN modular attachment system
- Burglar-resistant, bullet-proof and fire protection designs with identical sight lines achievable by means of a small number of additional parts compared to the basic standard design.
- Sight lines of 50, 60, 65, 70 and 90 mm
- CE marking according to EN 13830

Integrated opening elements

- WICLINE 65, WICLINE 77 and WICLINE 125 window series with visible or concealed sashes
- Turn, turn/tilt, tilt and parallel sliding/tilt windows
- Skylight windows
- Parallel outward sash and top-hung windows
- Horizontally/vertically pivoted windows
- WICLINE 77 ventilation flap
- WICSTYLE 65, WICSTYLE 77, WICSTYLE 81 and WICSTYLE 88 single- and double leaf door ranges (can be opened inwards and outwards)
- WICSLIDE lifting sliding doors and folding/sliding systems
- WICSTYLE 65ED automatic sliding door

WICTEC® 50

– Classic products for ev



WICTEC 50 is a fully-developed stick construction façade that has proved its value in projects world-wide. It provides the largest number of variations to fulfil all customer requirements.

With its narrow sight line of 50 mm and its construction depths of 50 to 260 mm, the system offers a particularly delicate appearance. WICTEC 50 is ideal for vertical or angled curtain walls, for inclined and three-dimensional glass roofs, as well as for spatial constructions. Its narrow sight line makes WICTEC 50 the first choice for use in conservatories and glazed extensions.

The flexibility of the WICTEC 50 façade range becomes apparent from the variations and enhancements that are available. Alongside the standard range, WICTEC 50 is also available in a high-insulation version, a version suitable for passive houses, a version with integrated pressure profiles, a fire protection or industrial façade and a number of other versions.

A basic construction for a wide variety of applications: WICONA Unisys

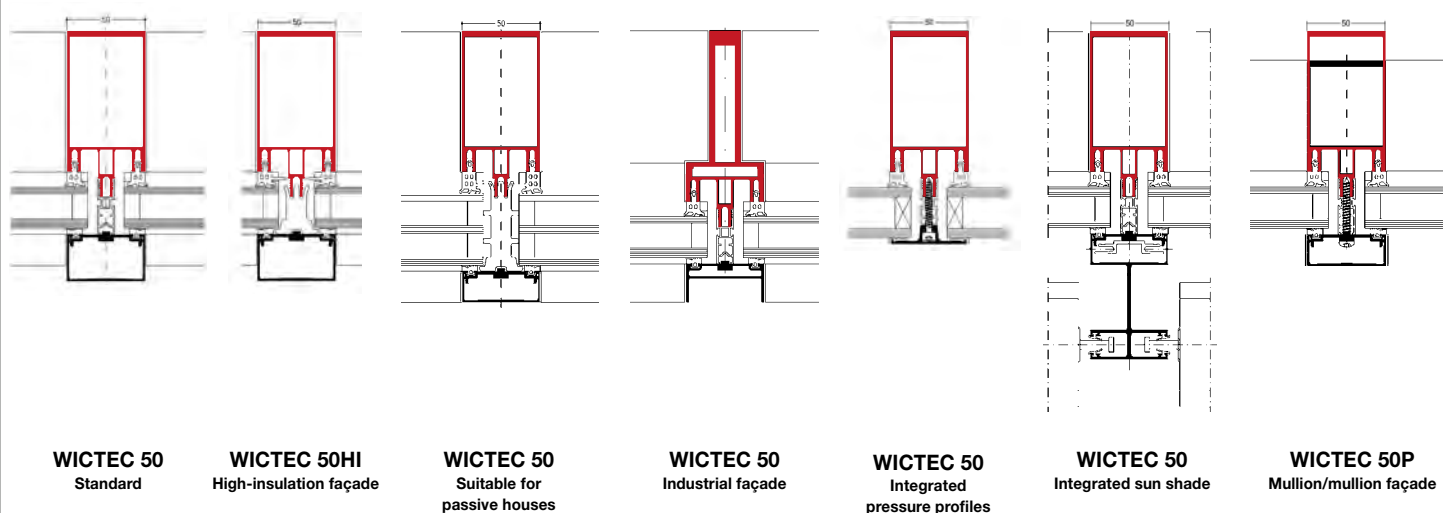

ery application

Variants

- WICTEC 50 Standard
- WICTEC 50HI High-insulation façade
- WICTEC 50 Suitable for passive houses
- WICTEC 50 Industrial façade
- WICTEC 50 Integrated pressure profile
- WICTEC 50 Integrated sun shade
- WICTEC 50P Mullion/mullion construction
- WICTEC 50E Mullion/mullion construction
- WICTEC 50A Add-on construction
- WICTEC 50EH Burglar-resistant
- WICTEC 50DH Bullet-resistant
- WICTEC 50FP Fire protection façade
- WICTEC 50SG Structural glazing façade

WICTEC 50 - an overview

Potential applications:

- Modular construction, simple to customize
- Level, vertical or angled curtain façades
- Tilted and three-dimensional glazed roof constructions or spatial structures/polygons
- Conservatories or glazed extensions

Heat protection:

- U_f -value of 0.75 to 2.4 W/(m²K) in accordance with DIN EN 12412-2 or DIN EN ISO 10077-2

Sound proofing:

- Sound insulation up to R_w 46 dB (DIN 4109) in accordance with DIN EN 20140 Part 3

Burglar-resistance:

- Resistance classes from WK 1 to WK 3 in accordance with DIN V ENV 1627

Bullet-resistance:

- Bullet-resistance class FB4 (in accordance with DIN EN 1522) can be achieved

Fire protection:

- Fire-resistance class G30/F30
- Parapet panel of fire resistance class W90

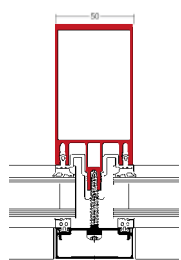

WICTEC 50E
Mullion/mullion façade

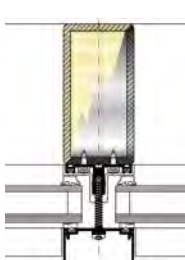

WICTEC 50A
Add-on construction
for steel and wood

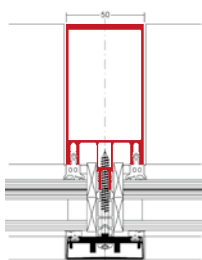

WICTEC 50EH
Burglar resistance

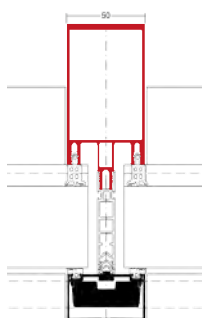

WICTEC 50DH
Bullet resistance

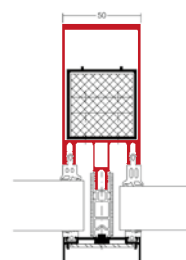

WICTEC 50FP
Fire protection façade

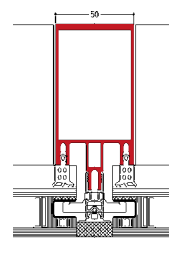

WICTEC 50SG
Structural glazing

WICTEC® 50 – Variants

WICTEC 50HI High-insulation façade	WICTEC 50 Integrated sun shade
<ul style="list-style-type: none"> ■ Enhancement of the WICTEC 50 standard façade with optimised thermal insulation ■ Thermal insulation: U_f-value of 0.75 W/(m²K) in accordance with DIN EN 12412-2 and DIN EN ISO 10077-2 ■ Insulation components from elastomers and infill thickness of 24-36 mm to meet more exactly heat insulation requirements ■ Optional upgrade suitable for passive buildings with 46 mm triple glazing ■ Wide range of possibilities to save energy ■ Improved insulation zone ■ Polygonal façades are possible ■ Burglar-resistant up to WK 2 in accordance with DIN V ENV 1627 	<p>Guide rails for sun protection are integrated into the external special cover profiles of WICTEC 50. The subsequent installation of fastening screws into the mullions is no longer necessary, nor is any additional or subsequent drilling necessary at the construction site.</p> <p>Benefits:</p> <ul style="list-style-type: none"> ■ The designing of the façade and its construction using WICTOP planning software includes all measurements for the sun protection and there is no need for further measurement or for the collection of data from drawings. ■ Modifications in the façade construction are automatically transferred to the measurement of the sun protection ■ Reliable and consistent manufacture and simple installation ■ The construction allows the use of blinds at high wind speeds of up to 25 m/s
WICTEC 50 Industrial façade	WICTEC 50P Mullion/mullion construction
<ul style="list-style-type: none"> ■ Industrial façade, profiles with technical structure ■ Creation of a steel finish on historical façades 	<ul style="list-style-type: none"> ■ Mullions and transoms of the same geometry – notching therefore not necessary ■ Overlapping via a horizontal plastic profile
WICTEC 50 Integrated pressure profile	WICTEC 50E Mullion/mullion construction
<ul style="list-style-type: none"> ■ Face width of the pressure profiles 51 mm or 43 mm ■ A simple construction, similar to the structural glazing look ■ Replaces the silicone joints of the SSG façade, which means that these bonded joints require no maintenance, approvals or third-party monitoring ■ Integrated pressure profiles (surface-mounted or flush fitting) 	<ul style="list-style-type: none"> ■ Mullions and transoms of the same geometry (the same profiles are used for each). Notching therefore not necessary ■ Overlapping by means of vertical and horizontal, single-piece overspanning EPDM gaskets

WICTEC 50A - Add-on construction	WICTEC 50FP Fire protection façade
<ul style="list-style-type: none"> ■ For steel and wooden supporting structures ■ The same mounting profile is used for mullions and transoms ■ Overlapping by means of vertical and horizontal, single-piece overarching EPDM gaskets ■ Installation is simplicity itself using bolt gun technology for steel substructures from 4 mm wall thickness 	<ul style="list-style-type: none"> ■ Fire-resistance class G30/F30 ■ Slim sight line: 50 mm ■ Infills: Glass or panel ■ Can also be combined with WICSTYLE FP fire protection doors ■ Overhead glazing possible ■ Suitable for indoor and outdoor use ■ Maximum unit height / floor to floor 5000 mm ■ Glazing panel sizes up to 1,800 x 3,000 mm (portrait format), or 2,400 x 1,400 mm (landscape format) ■ Length of fire protection façade unlimited ■ Polygonal façade up to +/-5° per mullion side with standard pressure profile ■ Fire protection in mullion and transom profiles requires only a small number of additional measures
WICTEC 50EH Burglar-resistance	
<ul style="list-style-type: none"> ■ Resistance classes up to WK 3 in accordance with DIN V ENV 1627 by incorporating additional security features in the mullion and transom profile, security features in the pressure profiles and by screwing the mullion profiles into the prechamber. ■ Façade construction based on WICTEC 50 standard façade ■ The same processing benefits as standard stick construction façades ■ Glazing compliant with DIN EN 356 ■ Construction depths correspond to WICTEC 50 Standard façade 	
WICTEC 50DH Bullet-resistance	WICTEC 50SG Structural glazing façade
<ul style="list-style-type: none"> ■ Bullet-resistance class FB4 in accordance with DIN EN 1522 ■ Façade construction based on WICTEC 50 standard façade ■ Basic construction with additional profiles ■ Offers the same processing benefits as the standard WICTEC 50 façade ■ WICLINE 65/77 and WICSTYLE 65/77 integration elements available in the same resistance class 	<ul style="list-style-type: none"> ■ Excellent U-values compared to conventional SSG (Structural Sealant Glazing) construction ■ Outstanding appearance ■ Time-saving, simpler and more cost-effective than SSG façades ■ Standard glazing spacers can be used ■ No problems with the gas tightness, improved insulation of the entire glass compound edge ■ Holder can be fitted before glazing is installed: Simple to install and remove. Holder locks at stopping point

WICTEC® 60

– Geometric designs



With its sight line of 60 mm, the WICTEC 60 façade series is ideal for flush-fitted curtain walls and angled glazed roof constructions.

This versatile construction allows the construction of aluminium-glass façades that incorporate complex geometries - such as transitions from level surfaces into angled or sloped façades. What is more, WICTEC 60 also fulfills the most stringent requirements in relation to burglar resistance (up to WK 3), bullet resistance (FB4) and fire protection (fire resistance classes G30 and F30). The functionality and utilisation of the system allows a wide variety of configurations, incorporating versatile elements such as windows, doors and sliding elements.

WICTEC 60 - an overview

- Stick type façades with 60 mm sight line internally and externally
- The range includes:
 - Vertical façades
 - tilted glazing and glazed roof constructions
 - Fire protection systems
- Infill thicknesses up to 51 mm
- Infill weights up to 4 kN. Weights carried by inserted aluminium glazing supports
- Dependable tightness by overlapping the mullion and transom gaskets with a moulded sealing piece
- Same width of the face of internal mullion and transom gaskets
- Integrated vapour pressure equalisation and drainage systems in each element or field
- Thermal insulation with U_f -values up to 1.2 W/(m²K) in accordance with DIN EN 12412-2 and DIN EN ISO 10077-2
- Screws either visible or concealed
- Integrated pressure profile provides a full and cost-effective alternative to bonded glazing
- Sound proofing: Sound insulation up to R_w 46 dB (DIN 4109) in accordance with DIN EN 20140 Part 3
- Burglar resistance: Resistance class WK 1 to WK 3, compliant with DIN V ENV 1627
- Bullet resistance: Bullet-resistance class FB4 in accordance with DIN EN 1522

WICTEC[®]
Unitized façades

– Precision pre-fabrication re



duces installation time

Today, most construction projects are subject to intense time pressure. When it comes to meeting demanding construction deadlines, WICONA unitized façades provide a solution, as production and installation can be precisely scheduled. The WICTEC EL unitized façades, together with WICTEC EL60 and WICTEC 50EL combine variation in design with a delicate appearance and cost-effective processing.

The individual façade units that form the construction can be pre-fabricated in your workshop under controlled conditions and fitted with glazing and parapets. Even additional elements such as sun shades and glare shields, or façade illumination systems can be installed in the workshop, irrespective of the weather conditions outside. Once on site, the pre-fabricated units are inserted into pre-arranged façade anchors, which means that installation can take place without the need for costly scaffolding. This pre-fabrication ensures that your client will receive a high quality product. It also facilitates the necessary logistical arrangements and the management that is required on site and a faster completion of the building.

Variants

- WICTEC EL
- WICTEC EL60
- WICTEC 50EL

WICTEC EL

The WICTEC EL system encompasses façade sight lines of 70 mm and 90 mm. In the case of single mullions, a sight line of 60 mm applies. The generous unit sizes ensure a particularly high-quality "glazed" appearance: up to 4,000 mm wide and 4,000 mm high; without central mullions up to 2,000 mm wide.

WICTEC Unitized façades - an overview

Profile technology:

- Main profiles in multi-chamber design
- Composite aluminium profiles from quality-assured and monitored production
- Slim sight lines of 70 and 90 mm for divided mullions and transoms and 60 mm for undivided mullions.
- Expansion tolerance horizontal 9.5 mm, vertical 8 mm
- 201 mm total construction depth of frame, mullion and transom profiles, including glass retaining profiles

Frame jointing technology:

- Element frame using conventional window frame jointing technology

Glazing:

- Dry glazing with EPDM glazing gaskets

– Additional variants



WICTEC EL60

This construction also constitutes a considerable improvement of the energy balance of a building, in that it achieves a U_f -value of up to $1.6 \text{ W/(m}^2\text{K)}$. Unit sizes of up to 2,800 mm wide and 3,500 high are possible using the WICTEC EL60 construction system, without central mullions of up to 1,500 mm wide.

WICTEC 50EL

This variant is based upon the WICTEC 50 stick construction façade and is modular in construction.

This means that you can use standard WICTEC 50 components to achieve thermal insulation. This enables U_f -values of up to $1.4 \text{ W/(m}^2\text{K)}$ to be achieved. Visually, the WICTEC 50EL system, with its slim sight line of 65 mm and its pressure profiles provide a mitred appearance.

The construction is suitable for element sizes of up to 3,000 mm wide and 3,500 high, or of 1,500 mm wide without central mullions.

WICTEC EL60 - an overview**Profile technology:**

- Identical construction depth of frames, supports and transoms
- Overall construction depth 198 mm
- Especially slim sight lines
 - 60 mm in the case of divided frames
 - 60 mm for undivided mullion and transom profiles
- Infills are made as frames with mitres (picture frame effect)
- Expansion gaps to take the gasket profiles and to link the elements together
- 9 mm expansion gap both vertically and horizontally, expansion absorption +5/–7 mm

Frame jointing technology:

- Element frames are fitted with corner angles and mechanically secured
- T-joint is secured using screws or jointing technology
- Transom – mullion connections with special connectors

Glazing:

- Internal and external glazing gaskets made from EPDM
- External glazing frame with mitred corner, with corner cleats and securing pins

Infill thicknesses:

- In transparent areas 22 – 36 mm, in parapet areas 4 – 12 mm

Thermal protection:

- U_f -values for frame combinations up to 1.8 W/(m²K), for mullion and transom profiles of up to 1,6 W/(m²K)

WICTEC 50EL - an overview**Profile technology:**

- Main profiles with thermal insulation strips from the WICTEC 50 range
- Especially slim sight lines
 - 65 mm in the case of divided frames
 - 50 mm for undivided mullion and transom profiles
- Expansion tolerance horizontal - 5 mm, vertical 5 mm
- Externally applied pressure or cover profiles

Frame jointing technology:

- Corner system with system corner angles
- Mullion and transom profiles with overlapping joints
- External cover profiles jointed to mitres

Glazing:

- Glazing gaskets from the WICTEC range

Infill thicknesses:

- In transparent and parapet areas 21 – 45 mm

WICTEC® FF

– State-of-the-art wind



ow façade

WICTEC FF is a very good example of the compatibility of WICONA systems developed in accordance with the purpose of the WICONA Unisys principle of making complex processes simple.

This is a window façade that completes the construction of a building and is used for punch windows or ribbon glazing. The characteristic features of the system are its external appearance that transcends the individual elements within the window structure. It can also take the form of a stick construction through the use of aluminium cover profiles that can be clipped on externally. The transparent areas of the façade consist of heat-insulated aluminium window elements.

The façade panelling can be executed in the form of equally heat-insulated wall or parapet elements, with optional rear ventilation or in pressure-released form. The WICTEC FF window elements are produced using WICTEC FF special frames in conjunction with the concealed sashes from the WICLINE 77 window range. The types of opening available include turn windows, turn-tilt windows, tilt windows, double casement windows and skylight ventilation sashes.

WICTEC FF - an overview

Profile technology:

- Main profiles in multi-chamber system
- Composite aluminium profiles from quality-assured and monitored production

Profile construction depths:

- 77 mm: Special frames
- 77/137 mm: Transom crossbars, crossbar profiles and expansion crossbars
- 80.5 mm: concealed sashes

Fittings:

- RAL-tested
- Sash weights:
 - Standard: 100 kg to 130 kg
 - Hidden fittings up to 130 kg

WICKSKY® 3 **WICTEC® 50SG**

– Beauty in glass



Structural glazing façades have a firm place in contemporary architecture and are used to create buildings which, as far as their urban aesthetic is concerned, stand out by virtue of their impressive appearance.

WICKSKY 3

WICKSKY 3 is your ticket to the structural glazing façades segment. The system is based upon the WICTEC 50 stick construction façade system and enables you to achieve structural glazing façades of the highest technical standards.

In the case of this system too: WICKSKY 3 stands out by virtue of its simple and cost-effective processing. The individual infill units – fixed glazing, sashes, parapets – are each installed individually. If at some point in the future, it becomes necessary for one of those units to be replaced, it will be possible to replace any individual field, without affecting the neighbouring fields.

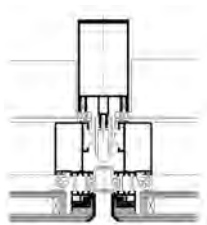

WICTEC 50SG

In the majority of cases, structural glazing façades are constructed using conventional SSG technology. This process is however very time-consuming and expensive, especially in view of the large amount of supervision that is required. With its WICTEC 50SG façade, WICONA is opening up a new, simpler system for the construction of structural glazing façades that is based upon a mechanical retention system.

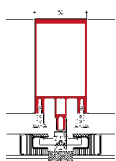

WICKSKY 3 - an overview

- The WICTEC 50 stick façade system forms the basic construction of WICKSKY 3.
- The unit retention system consists of two support blocks and 3-4 internal locking components (depending upon structural requirements). The system allows for +/- 4 mm of horizontal and vertical movement between units.
- The unit frame provides comprehensive thermal insulation and makes use of WICONA's tried-and-tested polyamide composite strips. Bringing together the corners of both profile shells ensures that the frame is highly stable.
- Version incorporating insulated glass as part of a system of multiple panels of insulated glass or as a single panel in the case of parapets.
- The outer 8 mm ESG-H-panel incorporates a 45° edge chamber, which is held by a black anodized corner profile along its entire length. Additional mechanical fixings such as collars or angle brackets are not required.
- Opening elements in the form of outward-opening top-hung elements.

WICTEC 50SG - an overview

- Outstanding visual appearance alike conventional SSG façades
- The underlying structure is that of the WICTEC 50 façade and the glazing is simply installed on site
- This system is simpler and more cost-effective than conventional SSG façades.
- Individual approval for each use is not required: approval is provided instead in the form of ETA (European Technical Approval)
- Standard glazing spacers can be used
- No problems with the gas tightness, improved insulation of the entire glass compound edge
- Holder can be fitted before glazing is installed: simple to install and remove. Holder locks at stopping point



– Top quality means no compro



One of the primary functions of a façade is to protect the people and valuables inside. That is why burglar resistance, bullet resistance and fire protection form an integral part of the technical development of WICONA façades.

Starting at a basic level, you can create an all-round safety and security package for your customer that is appropriate to the location of the building, the potential risk, and the individual wishes of the customer, without compromising the visual appearance of the façades.

To allow you to upgrade the basic construction to the desired level of security, we have implemented the WICONA Unisys principle consistently across the entire range. Standardised components with the same basic construction and the same profiles enable you to meet any local security requirements in any building, economically and quickly. For example, you can install fire-resistant, burglar-resistant or even bullet-resistant façade sections – the visual appearance will always remain identical.

WICTEC 50 and WICTEC 60 Burglar-resistant façade

- Resistance classes up to WK 3 in accordance with DIN V ENV 1627 by incorporating additional security features in the mullion and transom profile, security features in the pressure profiles and by screwing the mullion profiles into the prechamber.
- Façade construction based on WICTEC 50/60 standard façade
- The same processing benefits as standard stick construction façades
- Glazing compliant with DIN EN 356
- Construction depths correspond to WICTEC 50/60 Standard façade

WICTEC 50 and WICTEC 60 Bullet-resistant façade

- Bullet-resistance class FB4 in accordance with DIN EN 1522
- Façade construction based on WICTEC 50/60 standard façade with additional profiles
- Offers the same processing benefits as the standard WICTEC 50/60 façade
- WICLINE 65/77 and WICSTYLE 65/77 integration elements available in the same resistance class

mise on standards

WICTEC 50FP and WICTEC 60FP

Fire protection façades

No matter whether stairwells, extensions, hallways or glazed roofs – with WICTEC FP all types of façade and architectural concepts can be adapted and produced in accordance with the necessary protection requirements. WICTEC FP is fully compatible with the WICTEC 50 and WICTEC 60 standard façades, which means that fire protection can come to form a harmonic part of any tailor-made façade solution.

Further information:

- Fire-resistance class G30/F30
- Slim sight lines: 50 mm and 60 mm
- Infill: Glass or panel
- Can also be combined with WICSTYLE FP fire protection doors
- Overhead glazing possible
- Suitable for indoor and outdoor use
- Maximum height of element / floor to floor 5000 mm
- Length of fire protection façade unlimited
- Polygonal façade up to $\pm 5^\circ$ per mullion side with standard pressure profile
- Fire protection in mullion and transom profiles possible simply through the use of additional measures
- Uses existing tools

WICTEC W90 Fire protection panel

Parapet panels of fire resistance class W90 are incorporated into the façade if it is necessary to prevent fire from spreading from storey to storey. The building regulations in each of the German federal states, together with specific guidelines that relates to high-rise buildings, hospitals or schools, require glazed façades to incorporate fire barrier zones of 1,000 mm in height.

Fire protection panels generally take the form of comprehensive system solutions that have been granted a testing certificate from the buildings regulation authority. The WICTEC W90 fire protection parapet panels can be incorporated into WICTEC 50 and WICTEC 60 façade systems. The external surface of these is made up of glass or aluminium.





– Innovative products to



It is our aim that as a WICONA partner, you are able to distinguish yourself very clearly from the competition and will therefore achieve greater success than your competitors.

That is why we are continually working to develop our products and why our innovations are setting new standards within the sector. We consider the technical requirements of the future as our core challenge.

At WICONA, aspects such as thermal insulation, climate protection and sustainable construction all form key considerations within our current developments and will do so to an increasing extent in the future.

It is our wish to offer you the very best solutions that will enable you to provide your customers with the perfect solution for their requirements. The field of aluminium profile systems for façades in particular is one area in which the WICONA brand is playing a pioneering role. Our pioneering spirit has resulted in solutions that have set new standards in terms of ecology, design, flexibility, thermal protection and sound proofing. And we will continue to progress along that road - with you by our side.

Integrated sun shade

The principle: Guiderrails for the sun protection are integrated into the external cover profiles of the stick construction of the WICTEC 50 façade system. The subsequent installation of fastening screws into the mullions is no longer necessary, nor is any additional or subsequent drilling necessary at the construction site. The plastic-coated fastening elements of the exterior blinds are free-floating, so that the transmission of sound through the structure is reduced, the exterior blinds run quietly and changes in length resulting from thermal factors are compensated for.

ensure greater market success

TEmotion – the intelligent façade concept

TEmotion is an intelligent façade concept that has been developed by WICONA. The façade reacts to changes in outdoor and indoor conditions, such as light or temperature, and therefore makes a significant contribution to improving the energy efficiency of the building envelope and reducing the operating costs. TEmotion not only incorporates technical components, but also includes the relevant sensors and control systems. The individual elements can therefore adjust automatically to the changing situations within and outside the building. The intelligent façade controls the integrated ventilation, air-conditioning and heating technology, adjusts the sun protection and prevents the interior from overheating.

At the same time, an adaptive light control system ensures dazzle-free, indirect natural daylight at the level required for the user. By automatically opening façade elements, it allows the building to be “flushed” with fresh air at night, considerably reducing the costs of cooling it artificially. In contrast to conventional façades, using TEmotion saves 40 to 50 per cent of the primary energy otherwise used for heating, cooling, ventilation and illumination. The fact that energy savings of that level can also be achieved in existing buildings is demonstrated by the intelligent façade system such as the one that has been installed at the WICONA training centre in Bellenberg.

WICSOLAIR sunshading

WICSOLAIR represents a comprehensive solution when it comes to providing external solar protection. As the system allows positioning of the slats at different angles and with different spacing, the sunshading can be optimally adjusted to the building. This individual adjustability not only improves the energy balance of the building, but also increases the users' comfort; the full scope of visual contact with the surroundings of the building can be preserved despite the protective shading. Alongside conventional surface treatment versions, the flexible system can also be fitted with photovoltaic elements.



TEmotion

If you want more, come



Advice

As you know, we at WICONA do not actually build façades. We supply you with all of the quality profiles, additional components and the relevant workshop tools and equipment that you will need. But that is by no means all.

We want you to achieve success in working with WICTEC façade systems and therefore provide you with detailed support throughout the entire designing, manufacturing and marketing processes.

The individual modules of the concept are closely geared towards your needs.

Advice

We believe that continual dialogue with you is vital. From support in equipping your workshop to providing professional advice on-site, you can always depend on the WICONA team. We do not view this dialogue as a one-way street, either, but take your suggestions and wishes onboard and incorporate them wherever feasible.



Internet

Software and Internet

In the WICTIP information platform and the WICTOP ordering and editing software, plus the two associated download and enhancement applications, we provide you with the computer-assisted tools you need to simplify and accelerate work processes in every phase of your business, enabling you to concentrate fully on the requests of your customers.

and get it!

Logistics

We do everything we can to keep the delivery times for your goods as short as possible. We have committed a great deal of investment to ensure our central warehouse is up to date with the very latest developments:

Workflows have been optimised and provisioning improved.

And of course we have also adapted our software to match with this higher speed.

Training

It is well known that if you stand still, you end up going backwards. That is why we will take you with us as we move forward: Practical and theory-based workshops, seminars and further training modules will provide you with the knowledge and expertise you need to achieve business success.



The training offer covers not only the WICONA product ranges, but goes much further: standards, guidelines and regulations change, software is constantly being refined and experience with customers and contractors always teaches us something new. At our seminars and events, you will receive the latest information to simplify your work. This too is an integral part of the WICONA service.



Logistics

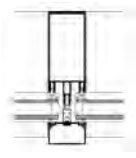

Training

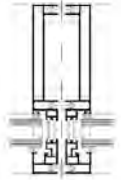
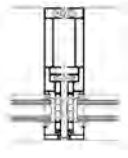
				
	WICTEC 50	WICTEC 60	WICTEC EL	WICTEC EL60
Construction type				
Stick construction façade	■	■		
Mullion/mullion façade	■ 50P, 50E			
Surface mounted construction for steel and wooden support structures	■ 50A			
Structural glazing	■ 50SG			
Unitized façade			■	■
Type of façade				
Insulated façade	■	■	■	■
Rear ventilated façade	■	■		
Glazed roofs	■	■		
Design				
Industrial design	■			
Structural glazing design	■ Integrated pressure profile			
Integrated sun shade	■			
Performance				
High thermal insulation	■ HI			
Fire protection	■ FP	■ FP		
Burglar-resistance up to WK 3	■ EH	■ EH		
Bullet resistance FB4	■ DH	■ DH		
Integrated opening elements:				
Windows/doors	■	■	■	■
Top-hung sashes, parallel vent windows	■	■		
Roof windows	■	■		

				
	WICTEC 50EL	WICTEC FF	WICTEC 50SG	WICKSKY 3
Construction type				
Stick construction façade			■	
Mullion/mullion façade				
Surface mounted construction for steel and wooden support structures				
Structural glazing			■	■
Unitized façade	■			
Type of façade				
Insulated façade	■		■	■
Rear ventilated façade		■		
Glazed roofs				
Design				
Industrial design			■	
Structural glazing design			■	■
Integrated sun shade				
Performance				
High thermal insulation				
Fire protection				
Burglar resistance				
Bullet resistance				
Integrated opening elements:				
Windows/doors	■	■		
Top-hung sashes, parallel vent windows			■	■
Roof windows				





Façade systems

WICTEC®

Façade series with wide range of application and intelligent system design



Door systems

WICSTYLE®

Door ranges comprising all the major functions with regard to thermal insulation, security and aesthetics

WICSLIDE®

Sliding, lifting/sliding and folding/sliding elements support a wide range of design options for salesrooms and living rooms, conservatories and glass extensions



Window systems

WICLINE®

Window range with the technical functions and design options for any architectural plans



Security and safety

- Burglar resistance
- Bullet resistance
- Smoke control
- Fire protection



Fittings

WICSTAR®

Specially developed and designed fitting systems for all opening variants of the WICLINE window systems



Software

WICTOP®

Practical, complete software solution with optimum ease-of-use for façade, window and door construction



Equipment and tools

WICPRO®

Complete package of tools for safe and efficient working with WICONA profiles

WICPLOT®

AutoCAD application to provide professional support in creating technical drawings for metalwork constructions

WICTIP®

Online information platform for full, up-to-date documentation of all WICONA products

Façade systems

WICTEC®

Hydro Building Systems GmbH

Söflinger Straße 70
89077 Ulm/Donau
Germany
Phone +49 (0) 7 31 39 84-0
Telefax +49 (0) 7 31 39 84-2 41
www.wicona.com

